

# MAC CORPORATION'S STATIONARY Compactors

MAC 200

MAC 300

MAC 400



## STANDARD FEATURES

- NEMA 12 Remote Control Station on 13 ft Sealite
- Key-Lock Start Switch
- Red Mushroom-Head Stop Button
- Solid State Motor Starter Overload – Adjustable 13-50 Amp
- NEMA 12/13 Panel Box
- Side Mounted Power Unit
- Power Unit Weather Cover
- Power Unit Factory Ready for 208-230-460 Volt 3 Phase
- Automatic Motor Starter Reset

**MAC**  
CORPORATION

# MAC STATIONARY COMPACTORS



## QUALITY

By implementing the highest quality steel fabrication and welding techniques, MAC Corporation's stationary compactors are designed and engineered to efficiently and economically handle maximum loads and stresses in commercial and medium industrial situations.

## SAFETY

The MAC 200, 300, and 400 feature industrial grade electrical and hydraulic systems and conforms to all ANSI codes and safety requirements.

## OPTIONAL FEATURES

Compactors can be built for your specific needs with custom-fitted side or rear load hoppers, security chutes, drive on decks and other optional equipment.

## INDUSTRY EXPERTISE

Specializing exclusively in the manufacturing of refuse equipment, MAC Corporation provides over a century of combined experience in the industry. MAC Corporation provides quality equipment with cost-saving benefits.

## SPECIFICATIONS

	MAC 200	MAC 300	MAC 400
Mfr. Rating	2 cubic yards	3 cubic yards	4 cubic yards
Industry Rating	1.58 cubic yards	2.55 cubic yards	3.17 cubic yards
Clear Top Opening	58" x 42"	58" x 67.5"	58" x 79.5"
Hydraulic Cylinders	6" bore x 54" stroke x 4-1/2" rod	6" bore x 78" stroke x 4-1/2" rod	6" bore x 96" stroke x 4-1/2" rod
Ram Penetration	11"	10"	16"
Packing Force	Normal: 46,700 lbs. Maximum Pack-Out: 55,100 lbs.	Normal: 46,700 lbs. Maximum Pack-Out: 55,100 lbs.	Normal: 48,100 lbs. Maximum Pack-Out: 56,500 lbs.
Ram Face PSI	Normal: 27.3 PSI Maximum: 32.2 PSI	Normal: 27.3 PSI Maximum: 32.2 PSI	Normal: 28.2 PSI Maximum: 33.0 PSI
Hydraulic Pressure	Normal: 1650 PSI Maximum: 1950 PSI	Normal: 1650 PSI Maximum: 1950 PSI	Normal: 1700 PSI Maximum: 2000 PSI
Ram Face Dimensions	28.5" x 60"	28.5" x 60"	28.5" x 60"
Cycle Time	50 seconds	47 seconds	58 seconds
Motor	10 H.P. TEFC	15 H.P. TEFC	15 H.P. TEFC
Pump	11.5 GPM vane	17.5 GPM vane	17.5 GPM vane
Weight	4,600 lbs.	5,850 lbs.	8,550 lbs.
Frame Floor	3/8" plate	3/8" plate	1/2" plate
Frame Sides	3/16" plate	3/16" plate	1/4" plate
Breaker Bar	8" x 6" x 3/4" angle	8" x 6" x 3/4" angle	8" x 6" x 3/4" angle
Ram Face	3/4" plate	3/4" plate	3/4" plate
Ram Floor	3/8" T1 plate	3/8" T1 plate	3/8" T1 plate
Ram Top	1/4" plate	1/4" plate	1/4" plate
Ram Sides	1/4" plate	1/4" plate	1/4" plate
Ram Guides	UHMWPE	UHMWPE	UHMWPE

## DIMENSIONS

A	119-1/2"	173-3/4"	201"
B	45-1/2"	71"	82"
C	74"	102-3/4"	119"
D	38-1/4"	38-1/4"	38-1/4"
E	48"	48"	48"

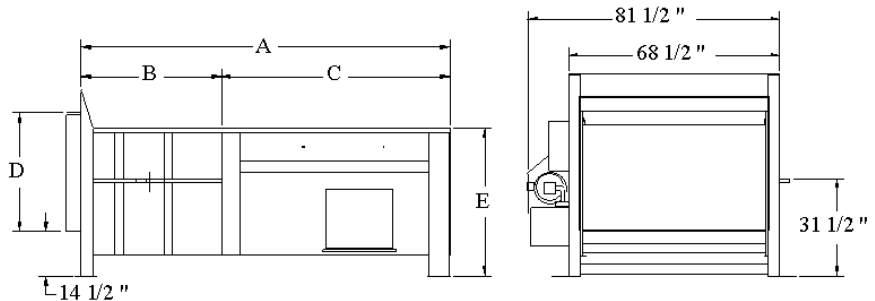

4717 Massachusetts Avenue  
Indianapolis, Indiana 46218  
Telephone **317-545-3341**  
Toll Free 1-800-447-5205  
Fax 317-545-8760

Pictures are for illustration only. Specifications are subject to change without notice to accommodate design changes. All compactors comply with ANSI regulations, OSHA standards, and all electrical components are UL certified.